

LEAK DETECT SYSTEM



The 2020 Dishwasher launch from Whirlpool Corporation now offers “Leak Detect” across the line-up, which is a combination of multiple features that measure and monitor the flow of water at various points. If a problem is sensed, the unit can take action by draining the tub and alerting you when necessary.

How It Works

1. A flow meter measures the amount of water that enters the dishwasher to ensure correct water volume.
2. If water is detected when it should not be present, the control activates an error to inform the consumer and activates the drain motor to drain away any water until the water ceases to flow or the consumer interacts with the product.
3. Water will overflow the front of the dishwasher tub lip and will enter the funnels. These funnels will direct water into the drip tray.
4. This sends a signal to the control to remove power to the fill valve, and it will cause the front light to flash.

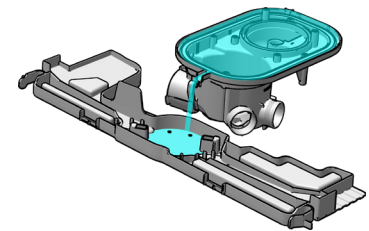
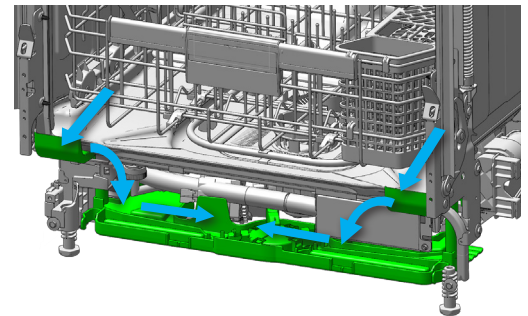

Leak Detect is Available Across the Dish Line-up

KitchenAid®

MODELS:

KDTE204K
KDFE204K
KDTM404K
KDFM404K
KDTM604K
KDPM604K
KDTM704K
KDPM704K
KDTM804K
KDPM804K



MODELS:

MDB9959SK
MDB8959SK
MDB7959SK
MDB4949SK

Whirlpool

MODELS:

WDTA50SAK
WDT750SAK
WDTA80SAK